



PUSH SWITCH

P/N:PS850-06



SPECIFICATIONS

Function: WITH LOCK
 Contact Arrangement: SPST, Normally Open
 Termination: THD version

Mechanical

Actuation Force: 240±30gf
 Life Expectancy: 10,000 Operations

Electrical

Contact Rating: 50mA @ 12V DC
 Dielectric Strength: 250V AC for 1minute
 Contact Resistance: 100mΩ Max.
 Insulation Resistance: 100MΩ Min.
 Travel: 2.5±0.5mm

Environmental

Operating Temperature: -25~+70℃
 Relative Humidity: (40℃)≤95%

Packaging

Bulk Package
 Inner Package: Plastic bag
 Outer Package: Carton

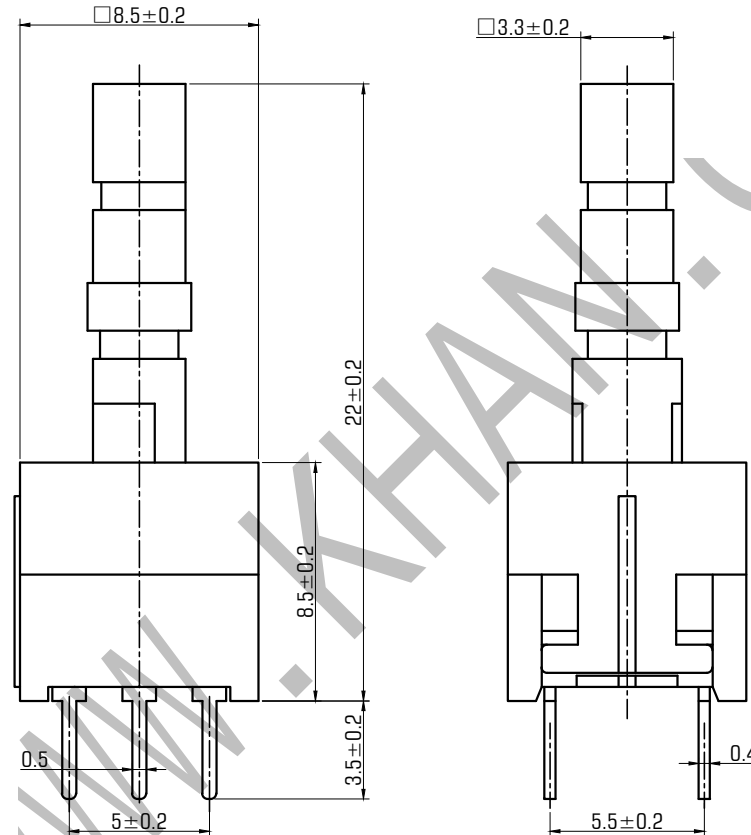

CIRCUIT DIAGRAM

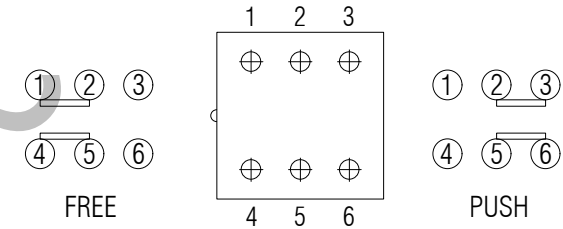

P.C.B. LAYOUT

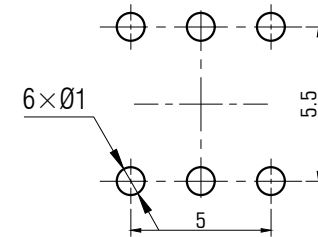

VERSION		PROJECTION	DESIGN	敖余达
KH14FE22E			DRAWN	敖余达
SCALE	SIZE	Dimensions are shown:mm(inches) 2018.10.15	APPROVAL	徐君辉
4:1	A4			