

TACT SWITCH

P/N: TSW06352

WATERPROOF



Professional Manufacturer Since 2000

SPECIFICATIONS

Function: Momentary action
 Contact Arrangement: SPST, Normally Open
 Termination: SMD version

Mechanical

Actuation Force: 180/230/280±50grams
 Life Expectancy: 100K Operations

Electrical

Contact Rating: 50mA @ 12V DC
 Dielectric Strength: 250V AC for 1minute
 Contact Resistance: 100mΩ Max.
 Insulation Resistance: 100MΩ Min.
 Travel: 0.3±0.1mm

Environmental

Operating Temperature: -25~+70°C
 Relative Humidity: (40°C) ≤95%

Materials

- 6. Cover: Black GP.PPA
- 5. Stem: Black GP.PPA
- 4. Washer: Rubber
- 3. Contact: Stainless Steel with Silver Cladding
- 2. Holder: Black GP.PPA
- 1. Terminal: Copper with Silver Cladding

Packaging

Bulk Package
 Inner Package: Plastic bag
 Outer Package: Carton

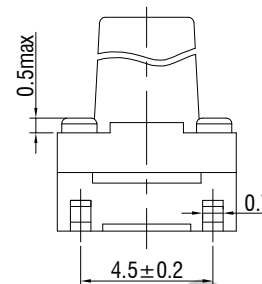
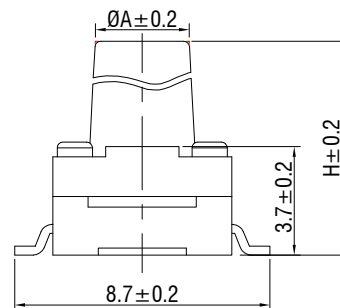

CIRCUIT DIAGRAM

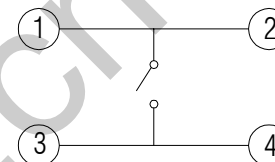

P.C.B. LAYOUT

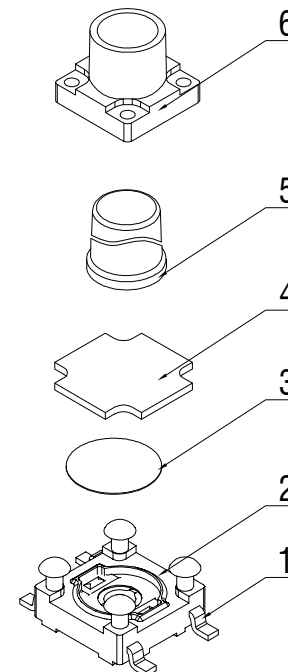
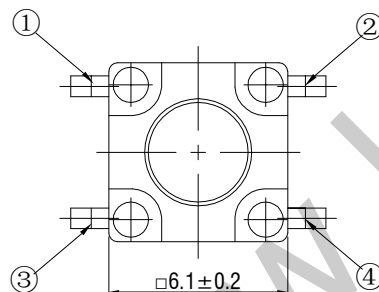
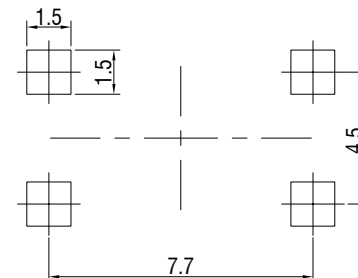

H	8	8.5	9	9.5	10	10.5	11	11.5	12	12.5	13
A	3.2	3.2	3.1	3.2	3.2	3	3.1	3.2	3.2	3.2	3.2



WENZHOU KHAN ELECTRONIC

VERSION		PROJECTION	DESIGN	Shuqing Zhu
KH14FE22E			CHECKED	Wei Lin
SCALE	SIZE	Dimensions are shown:mm(inches)	APPROVED	Johan Xu
4:1	A4		2022.02.21	