

TACT SWITCH

P/N:TSA06321



SPECIFICATIONS

Function: Momentary action
 Contact Arrangement: SPST, Normally Open
 Termination: SMD version

Mechanical

Actuation Force: 180±50grams
 Life Expectancy: 100,000 Operations

Electrical

Contact Rating: 50mA @ 12V DC
 Dielectric Strength: 250V AC for 1minute
 Contact Resistance: 100mΩ Max.
 Insulation Resistance: 100MΩ Min.
 Travel: 0.25±0.1mm

Environmental

Operating Temperature: -25~+70°C
 Relative Humidity: (40°C) ≤95%

Materials

5.Stem: Black GP.PPA
 4.Cover: Ferrum with Nickelplate
 3.Contact: Stainless Steel with Silver cladding
 2.Holder: Black GP.PPA
 1.Terminal: Copper (H62Y t=0.3) with Silver Cladding

Packaging

Bulk Package
 Inner Package: Plastic bag
 Outer Package: Carton

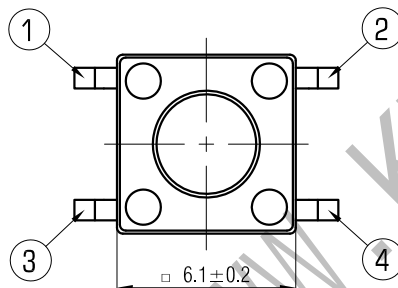
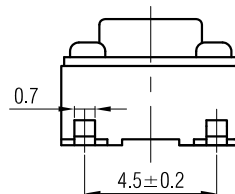
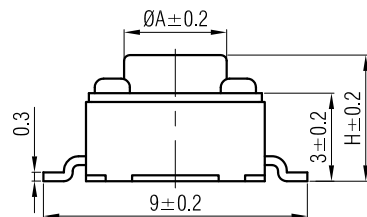

CIRCUIT DIAGRAM

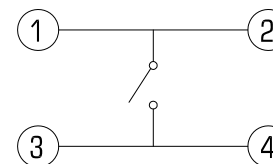

P.C.B. LAYOUT

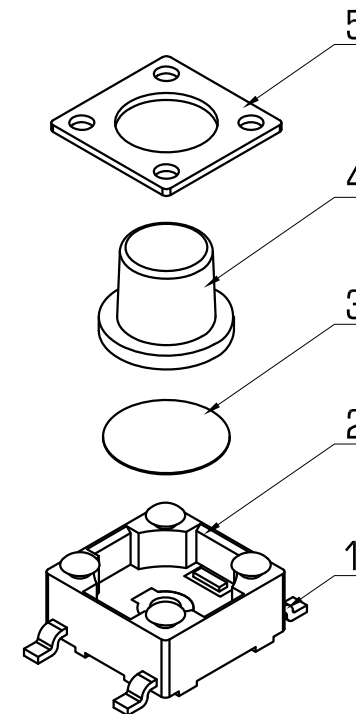
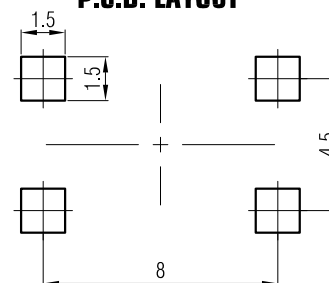

H	3.3	3.5	3.8	4	4.5	5	5.4	5.5	5.6	6
A	3.4	3.4	3.4	3.4	3.2	3.2	3	3.2	3.1	3.2
H	6.3	6.5	7	7.5	7.8	8	8.5	8.7	8.9	9
A	3.2	3.2	3.2	3.2	3.1	3.1	3.2	3.1	3.2	3.2



WENZHOU KHAN ELECTRONIC

VERSION		PROJECTION		DESIGN
KH14FE22E		 Dimensions are shown:mm(inches)		DRAWN
SCALE	SIZE			APPROVAL
1:1	A4	2019.06.27		